

# Preparing the Parts

The parts have been assembled in reverse for shipping, with the Oil Infuser Knob attached underneath the Glass Lid. Before assembling the Glass Lid, disassemble the parts by unscrewing the Nut on top of the Glass Lid.



Shipping Configuration

# Knob Assembly

1. Place the Oil Infuser Knob on a flat surface with the built-in screw facing upward.
2. Place the Knob Ring on top of the Oil Infuser Knob. The square notches on the bottom of the Knob Ring should face upward.
3. Place the Glass Lid on top of the Knob Ring, guiding the screw on the underside of the Oil Infuser Knob through the hole in the Glass Lid.
4. Place the raised section of the Plastic Washer through the hole in the Glass Lid, with the screw going through the center of the Plastic Washer.
5. Place the Metal Washer on top of the Plastic Washer, with the screw going through the center of the Metal Washer.
6. Thread the Nut onto the screw. Using your fingers or a wrench to hold the nut in place, turn the Oil Infuser Knob clockwise to tighten. When fully tightened, the Oil Infuser Knob should not move.

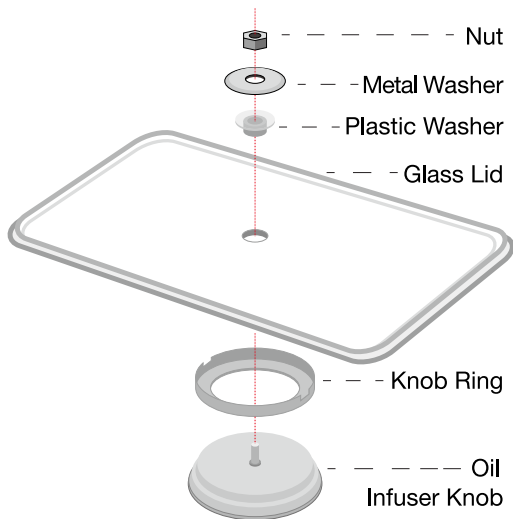

**NOTE:** You may need pliers or an adjustable wrench to tighten the screw.



Fully Assembled Lid

## Caution

The Glass Lid and Handle get very hot. Always use oven mitts.